



# RVCMB-78C

## REAR-VIEW INTEGRATION w/ CAMERA FOR SELECT MERCEDES BENZ C-CLASS & GLK 2007-2010

---

### INCLUDED IN THE BOX:

- (1) MB-78C Interface Module
  - (1) MB-78C Harness (#22XX)
  - (1) MB-78C Universal Camera (C-02)
  - (1) C-02 Extension Harness
  - (1) LVDS to Composite RCA Input Adapter
- 

### SAFETY INSTRUCTIONS:

1. Read through mounting guidelines: Please read through all safety instructions and handling directions intently before installation and start up of the device.
2. Keep mounting guidelines: Keep the instruction manual and safety instructions for potential further reference.
3. Caution advises: Please follow all caution advises contained in the mounting guidelines.
4. Water and humidity: The device should not be operated near water or near a humidity source.
5. Warmness / heat: The device should not be set up in direct proximity of heat sources (e. g. power amplifier).
6. Electric power supply: The device should only be operated at a +12 volt vehicle electrical system.
7. Connection / electric power supply: Use the device only at a +12 volt vehicle electrical system. Make sure to have a proper ground.
8. Intrusion of objects or liquids: Please make sure that no objects or liquids can intrude the interior of the device!  
(Danger of short circuit!)
9. Repairs: You should call on qualified personnel, if: a plug or a connector have been damaged cables are damaged objects have fallen into the device or liquids have intruded it the product has been exposed to humidity the device doesn't function normally or if significant changes in the operating performance can be observed the product/casing has been damaged.
10. Operation: Start no operation that is likely to distract you for a prolonged time from road traffic or traffic related events – RISK OF ACCIDENT!!!
11. Warranty: The warranty will cease in case that: you open the device or the casing you carry out repairs single handed you use the device improperly the device shows damages caused by external forces or mischievous destructions.

**We assume no liability for damages to the vehicle or its passengers.**

---

### SERVICE AND COMMUNICATION:

All our products are manufactured under strict quality control. Each device is being tested before shipment. If nevertheless do occur problems or if you have technical questions, contact us directly:

Crux Interfacing Solutions Tech Support  
1 (855) 822-1348 (Mon - Fri - 9:00 AM - 5:00 PM)

In addition to constant product update and development related changes the instruction manuals of the devices are constantly edited and kept up to date. To enable us to provide you with the right information and support for the device you have got at hand please add the following information to every inquiry: Date of purchase, your name and address, item number and the type of your vehicle.

#### APPLICATIONS:

#### MERCEDES-BENZ

2007 - 2009 C-Class (W204)

2007 - 2010 GLK (X204)

#### PRODUCT OVERVIEW:

The interface allows you to connect any external video source (e.g. DVD player, Camera) to the screen system NTG4 Mercedes. In addition, the interface has a reverse camera activation (including automatic switching to the Reversing gear only).

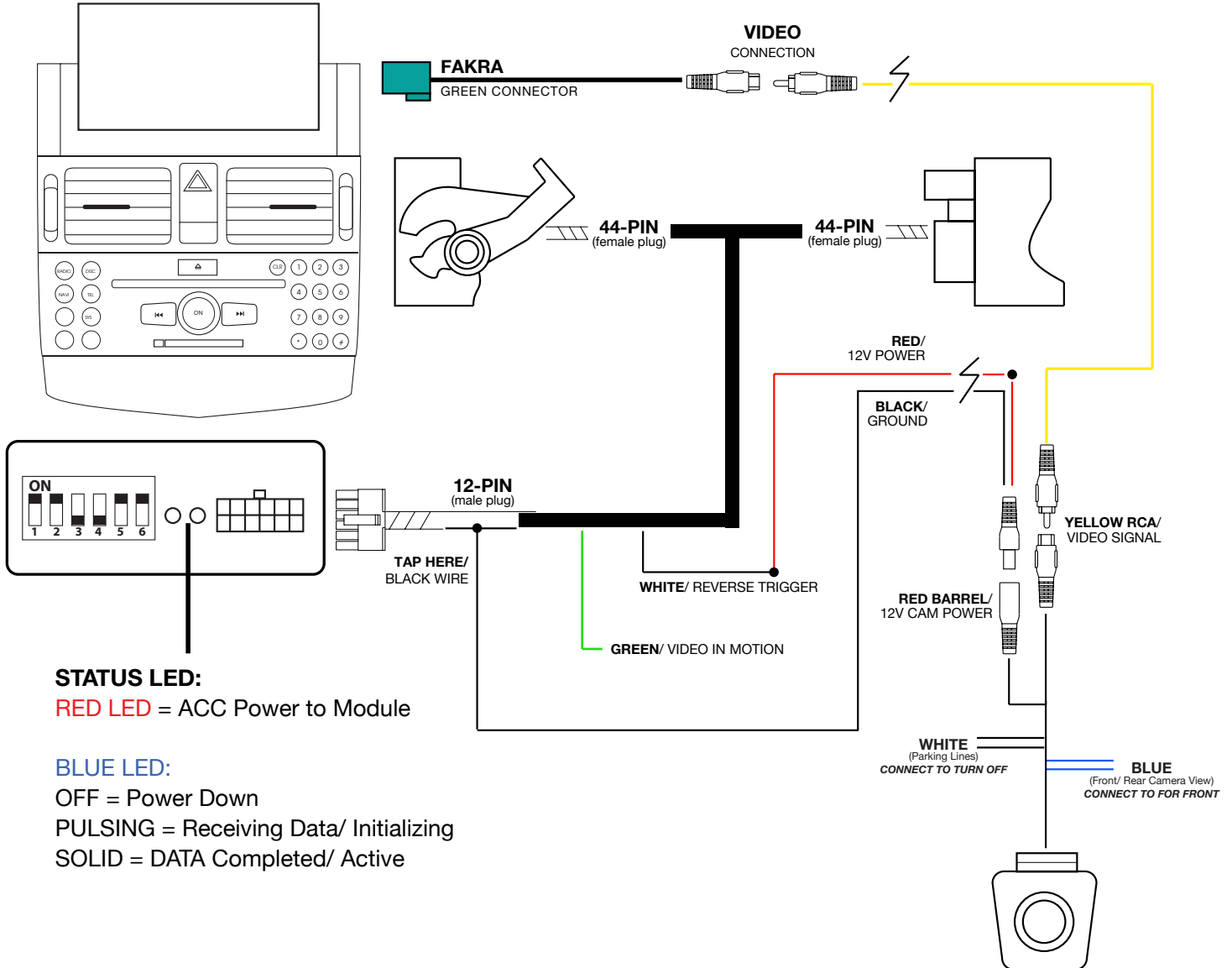

### APPLICATIONS:

#### MERCEDES-BENZ

2007 - 2009 C-Class (W204)

2007 - 2010 GLK (X204)

---

### INSTALLATION:

The following instructions are for a C-Class W204 Radio.

Warning: Do not install interface while ignition is on.

#### STEP 1

Pull out the ventilation unit using the appropriate tools.



#### STEP 2

Pull both TORX-Screws.



#### STEP 3

Slide up the latches located behind the now removed TORX-Screws.

Picture shows  
latches in locked  
position.

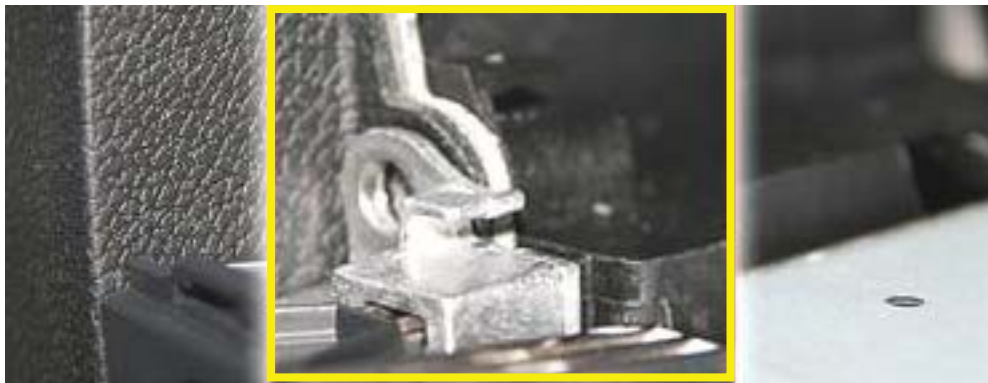

### APPLICATIONS:

#### MERCEDES-BENZ

2007 - 2009 C-Class (W204)

2007 - 2010 GLK (X204)

---

### INSTALLATION:

The following instructions are for a C-Class W204 Radio.

Warning: Do not install interface while ignition is on.

### NOTE:

Picture on the right shows the latch in the unlocked position.



---

### STEP 4

Disconnect the Quadlock connector from the Navigation unit and connect the provided T-Harness.



---

### STEP 5

Both 12-Pin inserts located in the original Quadlock connector and an optionally existing optical cable need to be reconnected to the T-Harness. Then back into the radio.

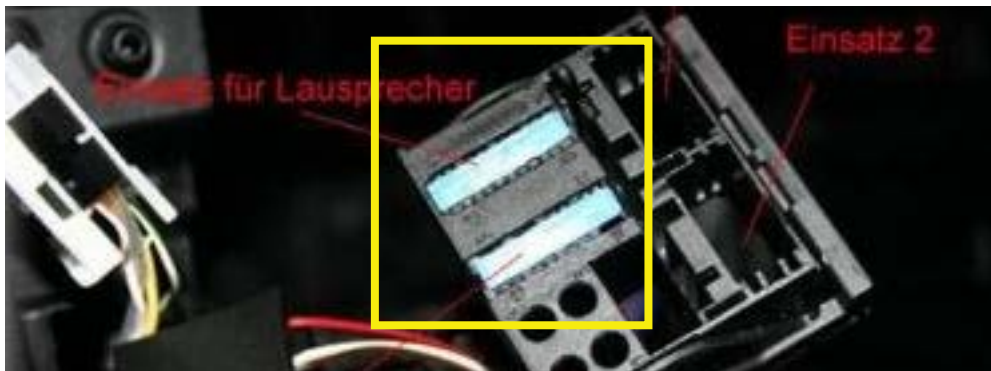

#### APPLICATIONS:

##### MERCEDES-BENZ

2007 - 2009 C-Class (W204)

2007 - 2010 GLK (X204)

#### INSTALLATION:

The following instructions are for a C-Class W204 Radio.

Warning: Do not install interface while ignition is on.

#### STEP 6

MULTI08: Connect the Fakra RCA Adapter (video cable) and the 18pin TYCO adapter (optional audio cable) between the navigation system and the external video/audio device.

MULTI08R: Connect the Fakra plug from the original rear-view camera and from the Fakra to RCA adapter to the switch box (video input).

Connect the Fakra plug (video output) from the switch box and the 18pin TYCO adapter to cinch (optional audio cable) to the navigation system.

Connect the loose black wire of the switch box to ground and the blue wire to the reverse gear signal (12 Volt).

Connect the Fakra to RCA Adapter (video) and the 18pin TYCO to Audio RCA.

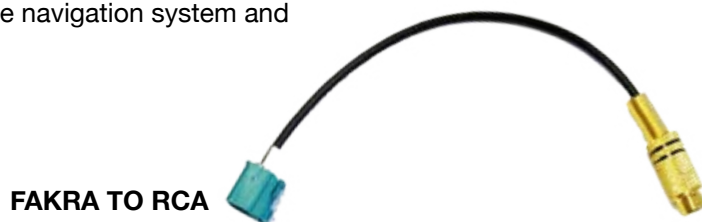

#### BACK OF RADIO



VIDEO INPUT

AUDIO INPUT  
(optional)

#### STEP 7

Test the rear-view camera system, then reassemble the radio into the center console.



#### APPLICATIONS:

##### MERCEDES-BENZ

2007 - 2009 C-Class (W204)

2007 - 2010 GLK (X204)

---

#### ACTIVATION USING THE SWC: MULTI08

The interface requires the user to activate the RVC feature.

**ACTIVATE:** In RADIO source, Press and Hold the “UP” and “+” buttons for 3 seconds

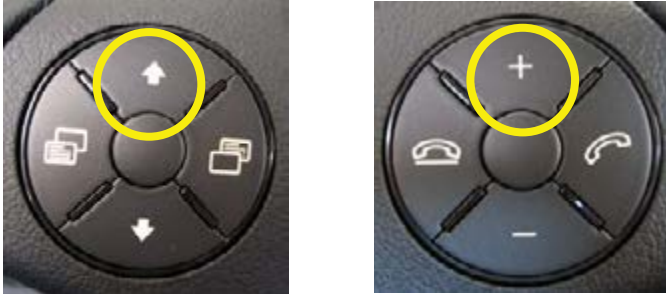

After the activation is successful,  
You will be able to access the AUX  
feature in the “VIDEO” option on the  
Main menu.

**DEACTIVATE:** In RADIO source, Press and Hold the “UP” and “-” buttons for 3 seconds

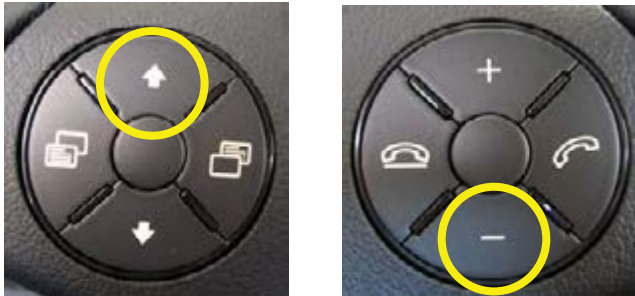

---

#### ACTIVATION USING THE SWC: MULTI08R

**ACTIVATE:** In RADIO source, Press and Hold the “UP” and “+” buttons for 3 seconds

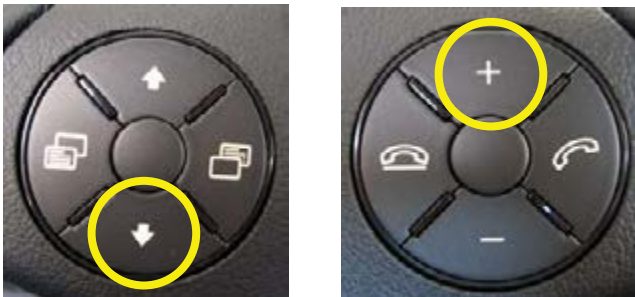

After the activation is successful,  
You will be able to access the AUX  
feature in the “VIDEO” option on the  
Main menu.

**DEACTIVATE:** In RADIO source, Press and Hold the “UP” and “-” buttons for 3 seconds

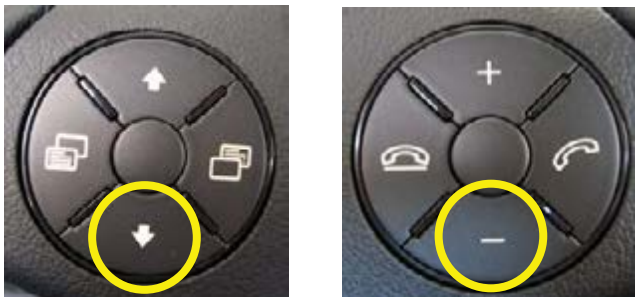

### APPLICATIONS:

#### MERCEDES-BENZ

2007 - 2009 C-Class (W204)

2007 - 2010 GLK (X204)

### SETTING THE DIP SWITCHES:

Set dip switches in following way:

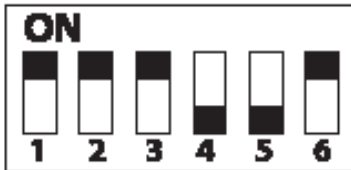

DIP 1 = Activate VIM ( must equipped with factory DVD Audio and VDO player )

DIP 2 = ON , Enable RVC Programming

DIP 3 = OFF

DIP 4 = OFF

DIP 5 = ON

DIP 6 = ON

### Important Note/ Troubleshoot:

#### 1. Activate or deactivate of RVC or AUX through SWC:

Turn Key to ACC or IGN , set Radio source to FM , Disconnect FM Antenna ( to avoid loud audio).

Push SWC simultaneously for 6 seconds, after releasing the buttons on SWC, if the factory displays pop up message " Diagnostic " and reboot, This is means the operation is successfully. If not, you will need to go back and try again.

For testing, there is no need to connect Rear view camera VDO source, just start the engine, shift to Reverse Gear. The screen should switch to the Rear View camera mode.

2. For De-activation RVC or AUX, set radio source to FM. Disconnect the FM antenna on the back of CDC unit, set volume up to about 75% , then start the deactivation process on Page 6.

#### APPLICATIONS:

##### MERCEDES-BENZ

2007 - 2009 C-Class (W204)

2007 - 2010 GLK (X204)

---

#### COMPATIBLE RADIO:



---

#### OPTIONAL AUX-INPUT CABLE

The 78CAUX cable allows you **ADD** an AUX input to your vehicle.



**Part: 78CAUX**  
(Sold Separately)