

Vehicle Applications

MERCEDES BENZ

with Comand NTG4

03/2007 – 02/2011	C-Class (W204)
09/2008 – Up	CLC-Class (CL203)
09/2008 – Up	GLK-Class (X204)
03/2010 – Up	SLS (C197)

with Comand NTG4-212

04/2009 – 05/2011	E-Class (W212)
05/2009 – 05/2011	E-Class Coupe (W207)
01/2011 – 05/2011	CLS-Coupe (C218)

with Comand NTG4.5

07/2011 – 08/2015	A-Class (W176)
11/2011 – 10/2014	B-Class (W246)
03/2011 – Up	C-Class (W204)
06/2011 – Up	C-Class Coupe (C204)
01/2013 – Up	CLA-Coupe (C117)
06/2011 – Up	CLS-Coupe (C218)
06/2011 – 10/2014	E-Class (S/W212)
06/2011 – Up	E-Class Coupe (C207)
07/2012 – Up	G-Model (G463)
11/2012 – Up	GL-Class (X166)
09/2013 – Up	GLA-Class (X156)
01/2011 – Up	GLK-Class (X204)
11/2011 – Up	ML-Class (W166)
03/2011 – Up	SLK-Class (R172)
2012 – Up	SL-Class (R231)

Features

- No Dealer programming required.
- Activates the Rear-View Camera function of the Comand NTG4, NTG4-212 or NTG4.5 radios.

Notes

- Compatible with Mercedes Benz Comand NTG4, NTG4-212 and NTG4.5 systems.
- Not compatible with Audio 20 systems.
- Compatible with NTSC cameras only.

Parts Included



RVCMB-780 Kit



Installation Instructions

For Comand NTG4 Installation

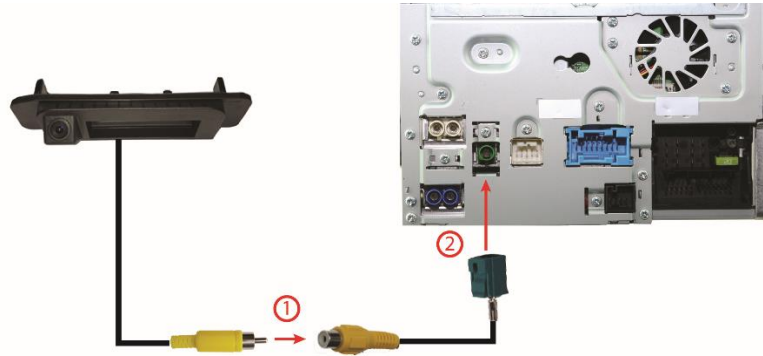

- 1 Connect the video RCA of the after-market rear-view camera to the female RCA connector of the RVCMB-780 video cable.
- 2 Connect the Fakra plug of the RVCMB-780 video cable on the green Fakra socket of the COMAND NTG4 unit.

For Comand NTG4-212 and NTG4.5 Installation

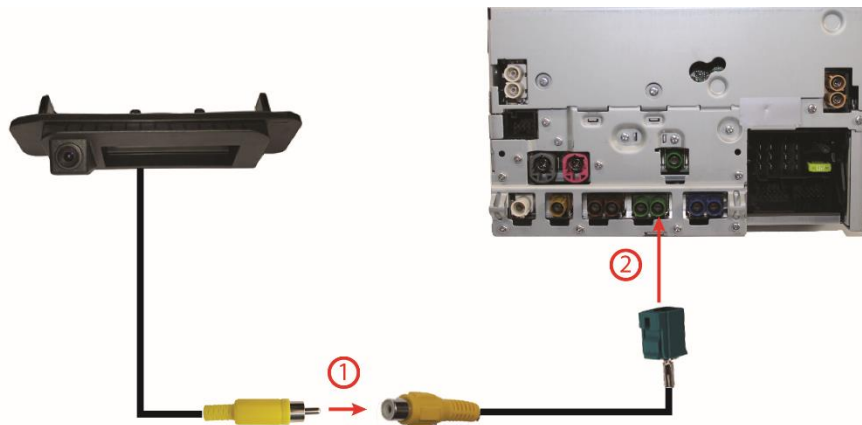

- 1 Connect the video RCA of the after-market rear-view camera to the female RCA connector of the RVCMB-780 video cable.
- 2 Connect the Fakra plug of the RVCMB-780 video cable on the right green Fakra socket of the COMAND NTG4.5 unit.



Coding the OBD II

1. Locate OBD-port and remove cover.
2. Turn on ignition to ACC.
3. Wait until the headunit has completely booted.
4. Plug the RVCMB-780 into OBD port.
5. Leave the RVCMB-780 for about 30 seconds or until you see a solid Green LED.
6. Remove the RVCMB-780 from the OBD port.

To reverse the coding, repeat steps 1-6.

Note: After the first use on a vehicle, the RVCMB-780 is personalized to this vehicle (head-unit) and can be used unlimited times to code or reverse coding ONLY on this vehicle.

LED Information:

LED	Status	Description
Green	Solid	Coding procedure successfully completed
	Flashing	Coding process in progress
Red	Solid	Remove coding procedure successfully completed
	Flashing	Coding process failed / license violation
Green + Red	Solid	CAN Communication Error! - Abort coding session

